



Specifications.

Number of pizzas 30 cm.	4
Productivity per hour.	60
Consumption of firewood per hour /kg./	3-4
Weight / kg /.	950
Electrical supply is 230 Volt/50-60 Herz.	

Model	DR 85K
Fuel type	WOOD-BURNING OVEN
Type	Rotary oven

WOOD-BURNING OVENS FOR PIZZAS (Series DR)

This is a wood oven with two front doors a rotating basis, wood combustion chamber, separated from the baking surface and drawer to collect ashes from burning wood.

By rotation of the base of the baking chamber a more uniformed performance, a higher productivity and better work conditions are achieved, since a pizza peel with a shorter handle is used. The rotation speed can be gradually increased and can be reversed as well. They are made of vibrated refractional material with high percent of two-aluminum-three-oxide (Al_2O_3), which guarantees high wearing out resistance and sturdiness. The domical form of the baking chamber guarantees an even baking at low wood consumption. Insulation materials with low coefficient of heat conductivity have been used. The considerable thickness of insulation helps to achieve maximum economy. All elements of the oven are placed in a case which allows its mobility.

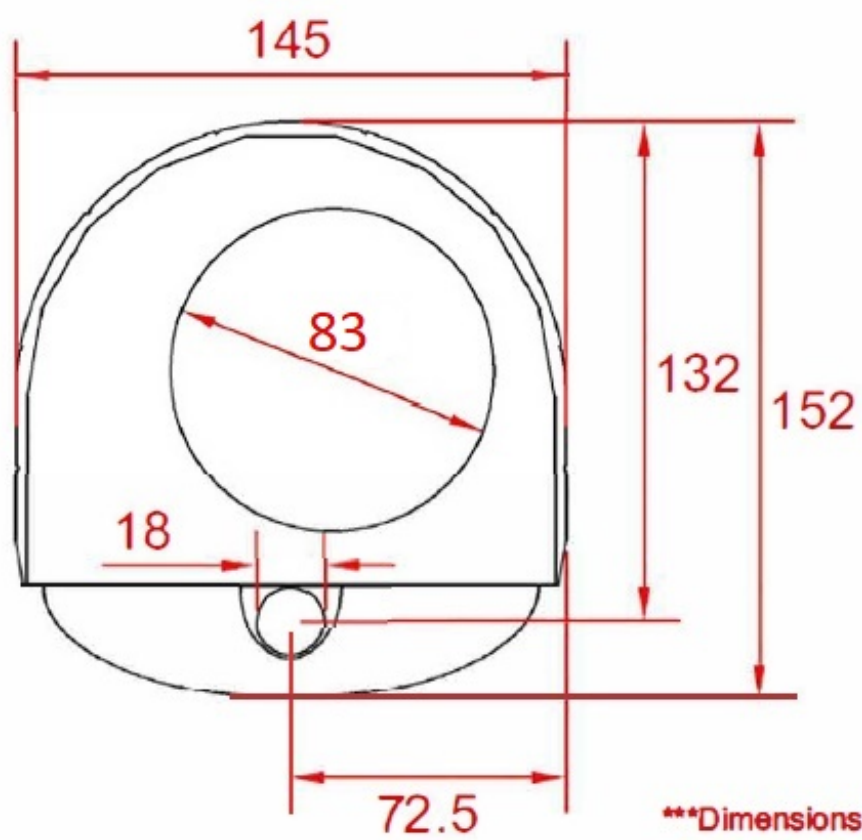
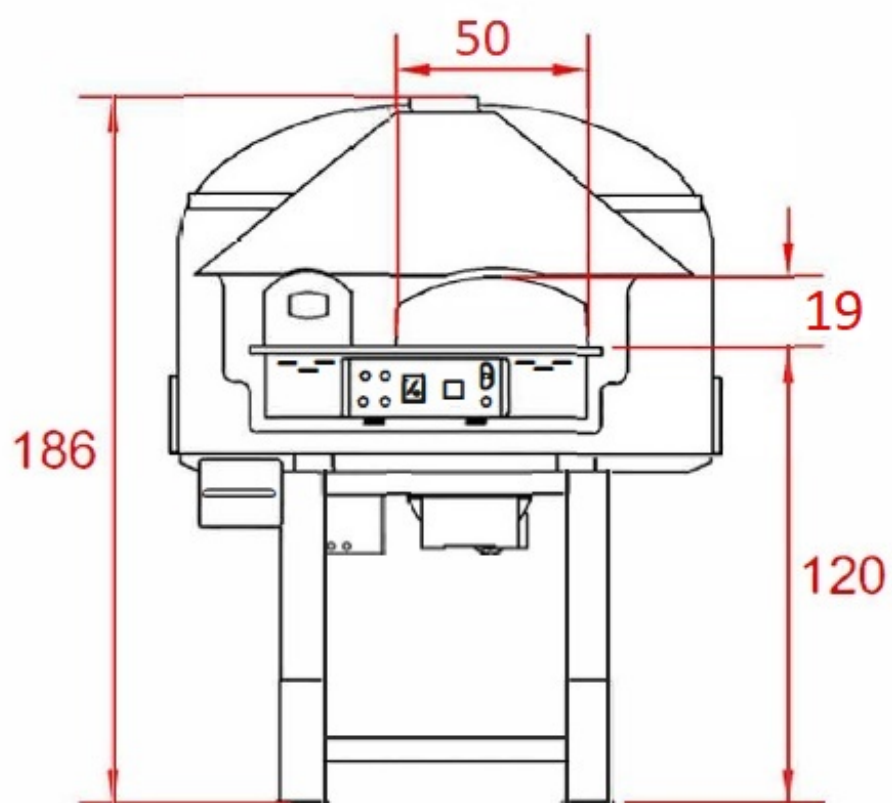

***Dimensions are cm.